

Sequence Modular Valves / Counterbalance Modular

Specifications

Model Numbers	Max. Operating Pressure MPa	Max. Flow L/min	Free Flow L/min
MHP-03- *-20	25	50	—
MH *-03- *-20			70

Model Number Designation

MHP	-03	-C	-20
Series Number	Valve Size	Pres. Adj. Range MPa	Design Number
MHP: Sequence Valve for P-Line	03	N: ★-1.8 A: 1.8-3.5 B: 3.5-7 C: 7-14	20
MHA: Counterbalance Valve for A-Line			20
MHB: Counterbalance Valve for B-Line			20

★See the "Min. Adjustment Pressure vs. Max. Flow" of this page.

Instructions

The minimum adjustment pressure equals the value obtained from the minimum adjustment pressure characteristics plus the tank line back pressure of this page. This back pressure should include the value of the T-line pressure drop characteristics of the valves stacked to the base plate side of the modular valve.

To make pressure adjustment, loosen the lock nut and turn the pressure adjustment screw clockwise or anti-clockwise. For an increase of pressure, turn the screw clockwise. Be sure to re-tighten the lock nut firmly after making adjustment to the pressure.

Typical Performance Characteristics

Hydraulic Fluid: Viscosity 35 mm²/s, Specific Gravity 0.850

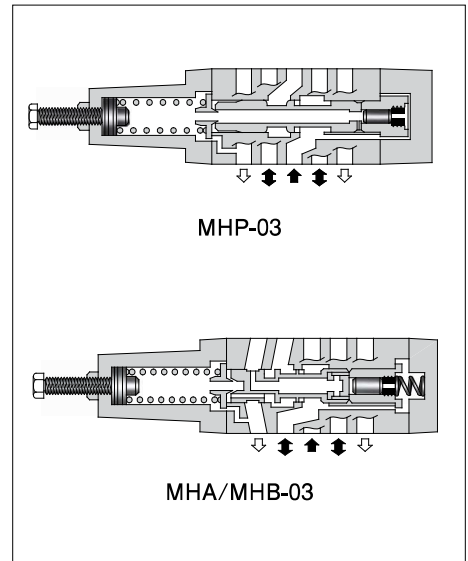
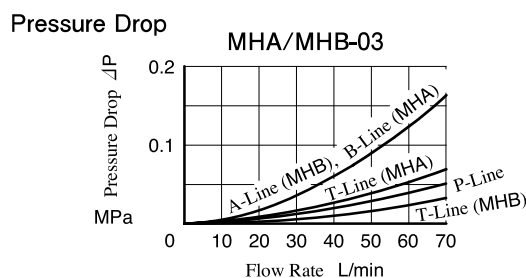
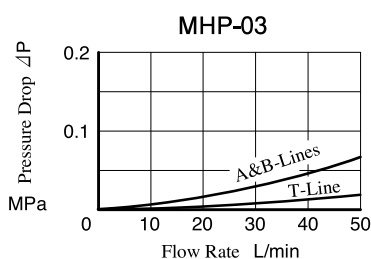
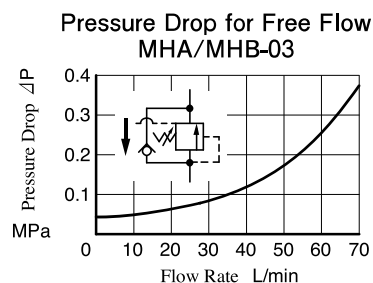
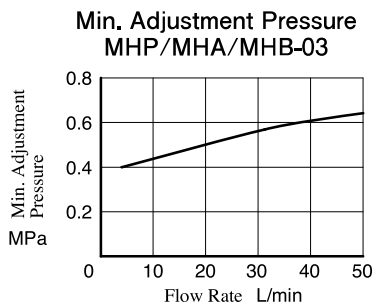

Model Numbers	Graphic Symbols	Graphic Symbols
MHP-03		
MHA-03		
MHB-03		

MHP-03

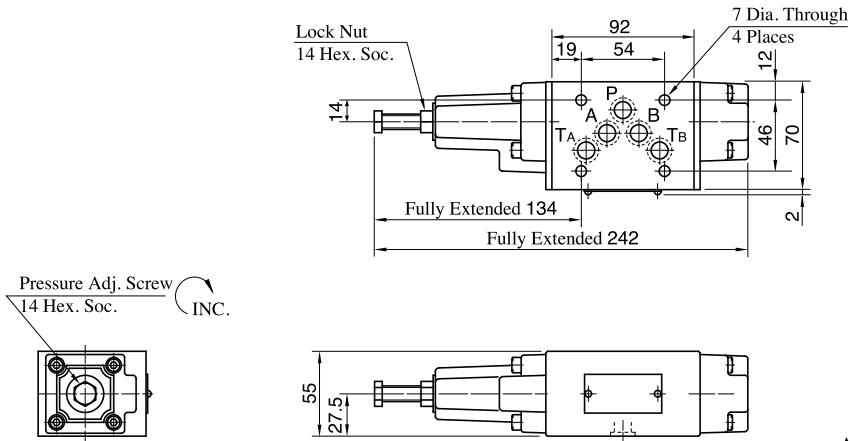

Approx. Mass.....3.5 kg

MHA-03

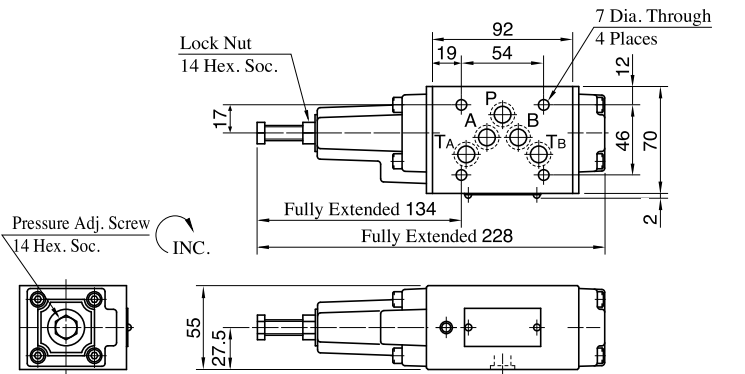

Approx. Mass.....3.5 kg

MHB-03

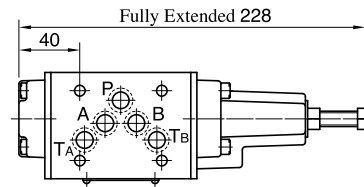

Approx. Mass.....3.5 kg

For other dimensions, refer to "MHA-03" in the drawing left..

List of Seals

MHP-03, MHA-03, MHB-03

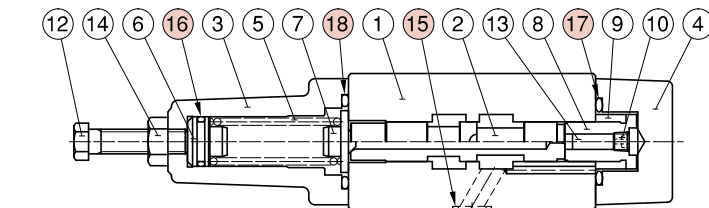

MHP-03

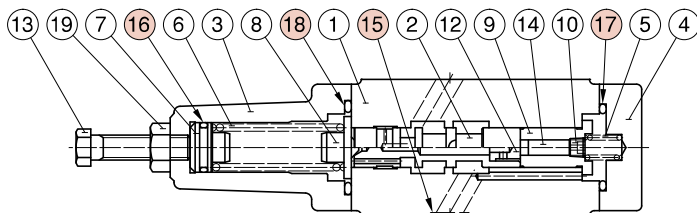

MHA-03

● MHB-03: The pressure adjustment part is assembled on the right side.

Item	Name of Parts	Part Numbers	Qty.
15	O-Ring	AS568-014 (NBR-90)	5
16	O-Ring	OR NBR-90 P16-N (OR NBR-70-1 P16-N)*	1
17	O-Ring	OR NBR-90 P29-N	1
18	O-Ring	OR NBR-90 P32-N	1

★ If use MHP-03, the O-Ring of item 16 use the one within brackets.